

Sierra View

RECORD OF FRIABLE AND NON-FRIABLE ACM
(FORM B)

Inspection Date(s) August 5, 2013

THREE-YEAR REINSPECTION

CDS CODE
04-61424-6003107

SCHOOL
Sierra View Elementary School

SCHOOL PHONE NUMBER
(530) 891-3117

ADDRESS (NUMBER) (STREET) (CITY) (ZIP)
1598 Hooker Oak Avenue Chico, CA 95926

-IMPORTANT-

Each building and functional space with friable ACM or friable assumed ACM listed on this form requires completion of FORM C (PHYSICAL AND HAZARD ASSESSMENT OF FRIABLE ACM OR FRIABLE ASSUMED ACM). Indicate location of material on blueprint, diagram or narrative in square or linear feet, and attach a copy (Sec. 763.93).

LINE	BUILDING NAME & FUNCTIONAL SPACE <small>(Indicate Address if Different From Above)</small>	CHECK ONE			CHECK ONE			
		SUR-FACING	TSI	MISC	ACBM		ASSUMED ACM	
					FRIABLE	NON-FRIABLE	FRIABLE	NON-FRIABLE
1.	STORAGE SHEDS 1 & 2 NO SUSPECT ACM							
2.	UNIT A - CLASSROOM 1			X				X
3.	UNIT B - CLASSROOMS 2-5	X		X		X		X
4.	UNIT C - LIBRARY			X				X
5.	UNIT D - RESTROOM BLDG.			X		X		X
6.	BOILER ROOM		X		X		X	
7.	UNIT E - CLASSROOMS 6-7			X				X
8.	UNIT F - CLASSROOMS 8-11	X		X		X		X
9.	UNIT G - MPR	X		X		X		X
10.	MECHANICAL ROOM (911) AND HOT WATER ROOM		X		X		X	
11.	UNIT H - CLASSROOMS 13-16			X				X
12.	UNIT I - CLASSROOMS 12 & 17			X				X
13.	UNIT J - RESTROOM BLDG.	X		X				X
14.	BOILER ROOM (921)		X				X	
15.	UNIT K - CLASSROOMS 18-21			X				X
16.	UNIT L - CLASSROOMS 22-23			X				X
17.	UNIT M - PORTABLES 24-26			X				X
18.	UNIT N - PORTABLE 27			X				X

Z:\Clients\Chico USD\13-2751 3 Year Reinspections\Sites\Sierra View ES\Sierra View Form B.wpd

See attached "Homogeneous Materials Records" for all materials and their locations by building. On Form B all buildings are listed, and a summary of all non-friable and friable material is provided. Friable materials and their locations are listed separately under each building on Form B.

**THREE-YEAR REINSPECTION
HOMOGENEOUS ACBM RECORDS**

Date of Inspection: August 5, 2013

District: Chico Unified School District

Inspector: Blake Howes

School: Sierra View Elementary School

Building: Unit A - Classroom 1

Material Class	Material	Homo. Mat. #	% Asb.	Ft ² /L.F.	Location	Condition: Code & Comments	Friable Yes/No
M	DRYWALL	93	ASSUMED POSITIVE	1,250 S	CLASSROOM 1	(4) (11) EXISTS BEHIND TAGBOARD.	N
M	2' X 4' CEILING PANELS FISSURE PATTERN	99	ASSUMED POSITIVE	960 S	CLASSROOM 1	(1) (4)	N
M	COVE BASE ADHESIVE	250	ASSUMED POSITIVE	120 L	CLASSROOM 1	(1)	N
M	CARPET ADHESIVE	251	ASSUMED POSITIVE	850 S	CLASSROOM 1	(1)	N

Z:\Clients\Chico USD\13-2751 3 Year Reinspections\Sites\Sierra View ES\Sierra View HMR.wpd

CONDITION CODE

General Condition: (1) Good (2) Damaged (3) Significantly Damaged (25% or more)

Change in Condition: (4) No (5) Yes (If Yes, explain under comments)

Abated: (6) Repaired (7) Removed (8) Encapsulated (9) Enclosed (10) Isolated & Restricted

Miscellaneous: (11) Inaccessible, no inspection data (12) Other (Explain under comments) (13) Non-Asbestos/Not Inspected

CONSULT ORIGINAL AND SUPPLEMENTARY INSPECTION REPORTS FOR MATERIALS WITH TRACE AMOUNTS OF ASBESTOS

**THREE-YEAR REINSPECTION
HOMOGENEOUS ACBM RECORDS**

Date of Inspection: August 5, 2013

District: Chico Unified School District

Inspector: Blake Howes

School: Sierra View Elementary School

Building: Unit B - Classrooms 2-5

Material Class	Material	Homo. Mat. #	% Asb.	Ft ² /L.F.	Location	Condition: Code & Comments	Friable Yes/No
S	PLASTER	3	1-5%	400 S	SPEECH ROOMS	(1) (4)	N
M	9" VINYL FLOOR TILE (GREEN) & ADHESIVE	14	1-5%	4,000 S	CLASSROOMS 2-5 AND SPEECH ROOMS	(1) (4)	N
M	TRANSITE PANELS	83	ASSUMED POSITIVE	25 PANELS	UNDER WINDOWS THROUGHOUT BUILDING	(1) (4)	N
M	12" ACOUSTIC CEILING TILE- 1/8" HOLE PATTERN	17	ASSUMED POSITIVE	4,000 S	CLASSROOMS 2-5 AND SPEECH ROOMS	(1) (4)	N
M	COVE BASE ADHESIVE	157	ASSUMED POSITIVE	600 LF	CLASSROOMS 2-5 AND SPEECH ROOMS	(1) (4)	N
M	9" VINYL FLOOR TILE (GRAY) & ADHESIVE	158	ASSUMED POSITIVE	400 S	SPEECH ROOMS	(1) (4)	N
M	STUCCO	255	ASSUMED POSITIVE	200 S	COVERED WALKWAY AT EAST END	(1)	N

Z:\Clients\Chico USD\13-2751 3 Year Reinspections\Sites\Sierra View ES\Sierra View HMR.wpd

CONDITION CODE

General Condition: (1) Good (2) Damaged (3) Significantly Damaged (25% or more)

Change in Condition: (4) No (5) Yes (If Yes, explain under comments)

Abated: (6) Repaired (7) Removed (8) Encapsulated (9) Enclosed (10) Isolated & Restricted

Miscellaneous: (11) Inaccessible, no inspection data (12) Other (Explain under comments) (13) Non-Asbestos/Not Inspected

J

CONSULT ORIGINAL AND SUPPLEMENTARY INSPECTION REPORTS FOR MATERIALS WITH TRACE AMOUNTS OF ASBESTOS

**THREE-YEAR REINSPECTION
HOMOGENEOUS ACBM RECORDS**

Date of Inspection: August 5, 2013

District: Chico Unified School District

Inspector: Blake Howes

School: Sierra View Elementary School

Building: Unit C - Library

Material Class	Material	Homo. Mat. #	% Asb.	Ft ² /L.F.	Location	Condition: Code & Comments	Friable Yes/No
M	12" ACOUSTIC CEILING TILE	97	ASSUMED POSITIVE	600 S	LIBRARY (902), AND ANNEX (902A)	(1) (4)	N
M	DRYWALL & JOINT COMPOUND	260	ASSUMED POSITIVE	1,500 S	LIBRARY (902) & ANNEX (902A) AT WALLS & CEILINGS	(1)	N
M	COVE BASE ADHESIVE	250	ASSUMED POSITIVE	400 L	LIBRARY (902), AND ANNEX (902A)	(1)	N
M	CARPET ADHESIVE	251	ASSUMED POSITIVE	1,150 S	LIBRARY (902), AND ANNEX (902A)	(1) (4)	N

Z:\Clients\Chico USD\13-2751 3 Year Reinspections\Sites\Sierra View ES\Sierra View HMR.wpd

CONDITION CODE

General Condition: (1) Good (2) Damaged (3) Significantly Damaged (25% or more)

Change in Condition: (4) No (5) Yes (If Yes, explain under comments)

Abated: (6) Repaired (7) Removed (8) Encapsulated (9) Enclosed (10) Isolated & Restricted

Miscellaneous: (11) Inaccessible, no inspection data (12) Other (Explain under comments) (13) Non-Asbestos/Not Inspected

CONSULT ORIGINAL AND SUPPLEMENTARY INSPECTION REPORTS FOR MATERIALS WITH TRACE AMOUNTS OF ASBESTOS

**THREE-YEAR REINSPECTION
HOMOGENEOUS ACBM RECORDS**

Date of Inspection: August 5, 2013

District: Chico Unified School District

Inspector: Blake Howes

School: Sierra View Elementary School

Building: Unit D - Restroom Bldg.

Material Class	Material	Homo. Mat. #	% Asb.	Ft ² /L.F.	Location	Condition: Code & Comments	Friable Yes/No
M	PLASTER	3	1-5%	1,500 S	CUSTODIAN CLOSET (904), BOY'S (907) & GIRL'S (905) RESTROOMS	(1) (4)	N
T	MUD JOINT	12	60-65%	30 L	BOILER ROOM (906)	(1) (4)	Y
M	DRYWALL & JOINT COMPOUND	150	N/A	N/A	BOY'S (907) & GIRL'S (905) RESTROOMS	(12) MATERIAL MISIDENTIFIED - RESTROOM WALLS & CEILINGS ARE PLASTER, SQUARE FOOTAGE ADDED TO HOMOGENEOUS MATERIAL #3	N/A
T	BOILER INSULATION	156	ASSUMED POSITIVE	1 UNIT	BOILER ROOM (906)	(1) (4)	Y

Z:\Clients\Chico USD\13-2751 3 Year Reinspections\Sites\Sierra View ES\Sierra View HMR.wpd

CONDITION CODE

General Condition: (1) Good (2) Damaged (3) Significantly Damaged (25% or more)

Change in Condition: (4) No (5) Yes (If Yes, explain under comments)

Abated: (6) Repaired (7) Removed (8) Encapsulated (9) Enclosed (10) Isolated & Restricted

Miscellaneous: (11) Inaccessible, no inspection data (12) Other (Explain under comments) (13) Non-Asbestos/Not Inspected

CONSULT ORIGINAL AND SUPPLEMENTARY INSPECTION REPORTS FOR MATERIALS WITH TRACE AMOUNTS OF ASBESTOS

**THREE-YEAR REINSPECTION
HOMOGENEOUS ACBM RECORDS**

Date of Inspection: August 5, 2013

District: Chico Unified School District

Inspector: Blake Howes

School: Sierra View Elementary School

Building: Unit E - Classrooms 6 & 7

Material Class	Material	Homo. Mat. #	% Asb.	Ft ² /L.F.	Location	Condition: Code & Comments	Friable Yes/No
M	DRYWALL	93	ASSUMED POSITIVE	1,700 SF	CLASSROOMS 6 & 7	(11) EXISTS BEHIND TAGBOARD.	N
M	12" VINYL FLOOR TILE & ADHESIVE	94	ASSUMED POSITIVE	120 S	CLASSROOM 6	(1) (4)	N
M	2' X 4' CEILING PANELS	99	ASSUMED POSITIVE	960 S	CLASSROOMS 6 & 7	(1) (4)	N
M	COVE BASE ADHESIVE	250	ASSUMED POSITIVE	175 L	CLASSROOMS 6 & 7	(1)	N
M	CARPET ADHESIVE	251	ASSUMED POSITIVE	900 S	CLASSROOMS 6 & 7	(1)	N

Z:\Clients\Chico USD\13-2751 3 Year Reinspections\Sites\Sierra View ES\Sierra View HMR.wpd

CONDITION CODE

General Condition: (1) Good (2) Damaged (3) Significantly Damaged (25% or more)

Change in Condition: (4) No (5) Yes (If Yes, explain under comments)

Abated: (6) Repaired (7) Removed (8) Encapsulated (9) Enclosed (10) Isolated & Restricted

Miscellaneous: (11) Inaccessible, no inspection data (12) Other (Explain under comments) (13) Non-Asbestos/Not Inspected

CONSULT ORIGINAL AND SUPPLEMENTARY INSPECTION REPORTS FOR MATERIALS WITH TRACE AMOUNTS OF ASBESTOS

**THREE-YEAR REINSPECTION
HOMOGENEOUS ACBM RECORDS**

Date of Inspection: August 5, 2013

District: Chico Unified School District

Inspector: Blake Howes

School: Sierra View Elementary School

Building: Unit F - Classrooms 8 - 11

Material Class	Material	Homo. Mat. #	% Asb.	Ft ² /L.F.	Location	Condition: Code & Comments	Friable Yes/No
S	PLASTER	3	1-5%	400 S	PIP ROOM (909) AND NURSES ROOM	(1) (4)	N
M	9" VINYL FLOOR TILE (GREEN) & ADHESIVE	14	1-5%	4,000 S	CLASSROOMS 8-11	(1) (4)	N
M	TRANSITE PANELS	83	ASSUMED POSITIVE	25 PANELS	UNDER WINDOWS THROUGHOUT BUILDING	(1) (4)	N
M	12" ACOUSTIC CEILING TILE - 1/8" HOLE PATTERN	97	ASSUMED POSITIVE	4,000 S	CLASSROOMS 8-11	(1) (4)	N
M	SHEET VINYL FLOORING & ADHESIVE	100	ASSUMED POSITIVE	50 S	RESTROOM (908)	(7)	N
M	9" VINYL FLOOR TILE (GRAY) & ADHESIVE	170	ASSUMED POSITIVE	500 S	RESTROOM (908), PIP ROOM (909), AND NURSES ROOM	(2) (5) DAMAGED AT RESTROOM (908) ENTRY	N
M	COVE BASE ADHESIVE	171	ASSUMED POSITIVE	520 LF	CLASSROOMS 8-11 & NURSE ROOM	(1) (4)	N
S	STUCCO	255	ASSUMED POSITIVE	300 S	COVERED WALKWAY @ EAST END OF BUILDING	(1)	N

Z:\Clients\Chico USD\13-2751 3 Year Reinspections\Sites\Sierra View ES\Sierra View HMR.wpd

CONDITION CODE

General Condition: (1) Good (2) Damaged (3) Significantly Damaged (25% or more)

Change in Condition: (4) No (5) Yes (If Yes, explain under comments)

Abated: (6) Repaired (7) Removed (8) Encapsulated (9) Enclosed (10) Isolated & Restricted

Miscellaneous: (11) Inaccessible, no inspection data (12) Other (Explain under comments) (13) Non-Asbestos/Not Inspected

CONSULT ORIGINAL AND SUPPLEMENTARY INSPECTION REPORTS FOR MATERIALS WITH TRACE AMOUNTS OF ASBESTOS

**THREE-YEAR REINSPECTION
HOMOGENEOUS ACBM RECORDS**

Date of Inspection: August 5, 2013

District: Chico Unified School District

Inspector: Blake Howes

School: Sierra View Elementary School

Building: Unit G - MPR

Material Class	Material	Homo. Mat. #	% Asb.	Ft ² /L.F.	Location	Condition: Code & Comments	Friable Yes/No
S	PLASTER	3	1-5%	1,200 S	KITCHEN (912), KITCHEN STORAGE (910), AND MPR CHAIR STORAGE	(1) (4)	N
T	PIPE WRAP INSULATION	8	15-20%	13 L	MECHANICAL ROOM (911)	(7)	
M	TRANSITE (CEMENTITIOUS) PIPE FLUE	98	ASSUMED POSITIVE	20 L	HOT WATER ROOM	(1) (4) THIS MATERIAL IS LOCATED IN THE MECHANICAL ROOM (911)	N
M	SHEET VINYL FLOORING (WHITE) & ADHESIVE	152	ASSUMED POSITIVE	50 S	KITCHEN RESTROOM	(1) (4)	N
M	DRYWALL	153	ASSUMED POSITIVE	3,000 S	OFFICES AND MPR (913) CEILINGS	(1) (4)	N
M	12" VINYL FLOOR TILE (WHITE / BLUE) & ADHESIVE	154	ASSUMED POSITIVE	3,500 S	OFFICE HALLWAY (914-916) & MPR (913)	(1) (4)	N
M	12" ACOUSTIC CEILING TILE - FISSURE PATTERN	155	ASSUMED POSITIVE	2,000 S	OFFICE HALLWAY CEILING, ALL THREE OFFICES (914-916), AND MPR (913)	(1) (4)	N
M	SHEET VINYL FLOORING (TAN) & ADHESIVE	159	ASSUMED POSITIVE	500 S	KITCHEN (912)	(1) (4)	N
M	COVE BASE ADHESIVE	250	ASSUMED POSITIVE	400 L	OFFICES (914-916), AND MPR (913)	(1)	N

Z:\Clients\Chico USD\113-2751 3 Year Reinspections\Sites\Sierra View ES\Sierra View HMR.wpd

CONDITION CODE

General Condition: (1) Good (2) Damaged (3) Significantly Damaged (25% or more)
Change in Condition: (4) No (5) Yes (If Yes, explain under comments)
Abated: (6) Repaired (7) Removed (8) Encapsulated (9) Enclosed (10) Isolated & Restricted
Miscellaneous: (11) Inaccessible, no inspection data (12) Other (Explain under comments) (13) Non-Asbestos/Not Inspected

**THREE-YEAR REINSPECTION
HOMOGENEOUS ACBM RECORDS**

Date of Inspection: August 5, 2013

District: Chico Unified School District

Inspector: Blake Howes

School: Sierra View Elementary School

Building: Unit G - MPR
(Continued)

Material Class	Material	Homo. Mat. #	% Asb.	Ft ² /L.F.	Location	Condition: Code & Comments	Friable Yes/No
M	SHEET VINYL FLOORING (GRAY) & ADHESIVE	268	ASSUMED POSITIVE	40 S	RESTROOM AT OFFICE (914)	(1)	N
M	COVE BASE ADHESIVE	270	ASSUMED POSITIVE	200 L	OFFICE HALLWAY	(1)	N
S	WALL TEXTURE	295	ASSUMED POSITIVE	700 S	OFFICES (914-916)	(1)	N

Z:\Clients\Chico USD\13-2751 3 Year Reinspections\Sites\Sierra View ES\Sierra View HMR.wpd

CONDITION CODE

General Condition: (1) Good (2) Damaged (3) Significantly Damaged (25% or more)

Change in Condition: (4) No (5) Yes (If Yes, explain under comments)

Abated: (6) Repaired (7) Removed (8) Encapsulated (9) Enclosed (10) Isolated & Restricted

Miscellaneous: (11) Inaccessible, no inspection data (12) Other (Explain under comments) (13) Non-Asbestos/Not Inspected

CONSULT ORIGINAL AND SUPPLEMENTARY INSPECTION REPORTS FOR MATERIALS WITH TRACE AMOUNTS OF ASBESTOS

**THREE-YEAR REINSPECTION
HOMOGENEOUS ACBM RECORDS**

Date of Inspection: August 5, 2013

District: Chico Unified School District

Inspector: Blake Howes

School: Sierra View Elementary School

Building: Unit H - Classrooms 13-16

Material Class	Material	Homo. Mat. #	% Asb.	Ft ² /L.F.	Location	Condition: Code & Comments	Friable Yes/No
M	TRANSITE PANELS	83	ASSUMED POSITIVE	4,500 S	STAFF ROOM (917) & CLASSROOMS 13-16	(1) (4)	N
M	12" VINYL FLOOR TILE (BLUE / WHITE) & ADHESIVE	94	ASSUMED POSITIVE	720 S	STAFF ROOM (917) & CLASSROOMS 13-16	(1) (4) STRIPS AT ROOM ENTRANCES WITH CARPET COVERING THE MAJORITY OF FLOOR SPACE.	N
M	2' X 4' CEILING PANELS FISSURE PATTERN	150	ASSUMED POSITIVE	3,600 S	STAFF ROOM (917) & CLASSROOMS 13-16	(1) (4)	N
M	SHEET VINYL FLOORING (BLUE & WHITE) & ADHESIVE	151	ASSUMED POSITIVE	100 S	MEN'S (918) & WOMEN'S (918A) RESTROOMS	(1) (4)	N
M	12" ACOUSTIC CEILING TILE - 1/8" HOLE PATTERN	160	ASSUMED POSITIVE	600 S	CLASSROOMS 13-16	(1) (4)	N
M	COVE BASE ADHESIVE	161	ASSUMED POSITIVE	480 S	CLASSROOMS 13-16	(1) (4)	N
M	CARPET ADHESIVE	251	ASSUMED POSITIVE	2,400 S	CLASSROOMS 13-16	(1)	N
M	DRYWALL & JOINT COMPOUND	300	ASSUMED POSITIVE	550 S	MEN'S (917) & WOMEN'S (918A) RESTROOMS	(1)	N
S	DRYWALL TEXTURE	301	ASSUMED POSITIVE	150 S	MEN'S (917) & WOMEN'S (918A) RESTROOMS	(1)	N

Z:\Clients\Chico USD\13-2751 3 Year Reinspections\Sites\Sierra View ES\Sierra View HMR.wpd

CONDITION CODE

General Condition: (1) Good (2) Damaged (3) Significantly Damaged (25% or more)

Change in Condition: (4) No (5) Yes (If Yes, explain under comments)

Abated: (6) Repaired (7) Removed (8) Encapsulated (9) Enclosed (10) Isolated & Restricted

Miscellaneous: (11) Inaccessible, no inspection data (12) Other (Explain under comments) (13) Non-Asbestos/Not Inspected

CONSULT ORIGINAL AND SUPPLEMENTARY INSPECTION REPORTS FOR MATERIALS WITH TRACE AMOUNTS OF ASBESTOS

**THREE-YEAR REINSPECTION
HOMOGENEOUS ACBM RECORDS**

Date of Inspection: August 5, 2013

District: Chico Unified School District

Inspector: Blake Howes

School: Sierra View Elementary School

Building: Unit I - Classrooms 12 & 17

Material Class	Material	Homo. Mat. #	% Asb.	Ft ² /L.F.	Location	Condition: Code & Comments	Friable Yes/No
M	2' X 4' CEILING PANELS FISSURE PATTERN	95	ASSUMED POSITIVE	1,920 S	CLASSROOMS 12 & 17	(1) (4)	N
M	12" VINYL FLOOR TILE (WHITE) & ADHESIVE	110	ASSUMED POSITIVE	250 S	CLASSROOM 12	(1) (4)	N
M	12" VINYL FLOOR TILE (WHITE) & ADHESIVE	162	ASSUMED POSITIVE	480 S	CLASSROOMS 12 & 17	(1) (4)	N
M	DRYWALL	163	ASSUMED POSITIVE	1,000 S	CLASSROOMS 12 & 17	(11) DRYWALL EXISTS BEHIND TAGBOARD.	N
M	COVE BASE ADHESIVE	250	ASSUMED POSITIVE	160 L	CLASSROOMS 12 & 17	(1)	N
M	CARPET ADHESIVE	251	ASSUMED POSITIVE	1,440 S	CLASSROOMS 12 & 17	(1)	N

Z:\Clients\Chico USD\13-2751 3 Year Reinspections\Sites\Sierra View ES\Sierra View HMR.wpd

CONDITION CODE

General Condition: (1) Good (2) Damaged (3) Significantly Damaged (25% or more)

Change in Condition: (4) No (5) Yes (If Yes, explain under comments)

Abated: (6) Repaired (7) Removed (8) Encapsulated (9) Enclosed (10) Isolated & Restricted

Miscellaneous: (11) Inaccessible, no inspection data (12) Other (Explain under comments) (13) Non-Asbestos/Not Inspected

CONSULT ORIGINAL AND SUPPLEMENTARY INSPECTION REPORTS FOR MATERIALS WITH TRACE AMOUNTS OF ASBESTOS

**THREE-YEAR REINSPECTION
HOMOGENEOUS ACM RECORDS**

Date of Inspection: August 5, 2013

District: Chico Unified School District

Inspector: Blake Howes

School: Sierra View Elementary School

Building: Unit J - Restrooms Bldg.

Material Class	Material	Homo. Mat. #	% Asb.	Ft ² /L.F.	Location	Condition: Code & Comments	Friable Yes/No
S	WALL PLASTER	4	ASSUMED POSITIVE	1,000 S	GIRL'S (922) & BOY'S (919) RESTROOM & CUSTODIAN CLOSET (920)	(1) (4) MINOR CRACKS.	N
T	HARD PACKED TSI FLUE ENCASED WITH METAL	98	ASSUMED POSITIVE	12 L	BOILER ROOM (921)	(11) THIS MATERIAL IS ENCASE IN METAL JACKET AND NOT ABLE TO BE ASSESSED - ASSUMED TO BE IN GOOD CONDITION.	Y
M	DRYWALL	164	ASSUMED POSITIVE	1,000 LF	BOY'S (919) & GIRL'S (922) RESTROOMS	(1) (4)	N

Z:\Clients\Chico USD\13-2751 3 Year Reinspections\Sites\Sierra View ES\Sierra View HMR.wpd

CONDITION CODE

General Condition: (1) Good (2) Damaged (3) Significantly Damaged (25% or more)

Change in Condition: (4) No (5) Yes (If Yes, explain under comments)

Abated: (6) Repaired (7) Removed (8) Encapsulated (9) Enclosed (10) Isolated & Restricted

Miscellaneous: (11) Inaccessible, no inspection data (12) Other (Explain under comments) (13) Non-Asbestos/Not Inspected

CONSULT ORIGINAL AND SUPPLEMENTARY INSPECTION REPORTS FOR MATERIALS WITH TRACE AMOUNTS OF ASBESTOS

**THREE-YEAR REINSPECTION
HOMOGENEOUS ACBM RECORDS**

Date of Inspection: August 5, 2013

District: Chico Unified School District

Inspector: Blake Howes

School: Sierra View Elementary School

Building: Unit K - Classrooms 18-21

Material Class	Material	Homo. Mat. #	% Asb.	Ft ² /L.F.	Location	Condition: Code & Comments	Friable Yes/No
S	PLASTER	4	ASSUMED POSITIVE	6,000 S	CEILINGS AT CLASSROOMS 18-21, CUSTODIAN (924)	(1)	N
M	TRANSITE PANELS	83	ASSUMED POSITIVE	16 PANELS	UNDER WINDOWS THROUGHOUT BUILDING	(1) (4)	N
M	12" VINYL FLOOR TILE (BLUE / WHITE) & ADHESIVE	94	ASSUMED POSITIVE	720 S	WORKROOM (923) & CLASSROOMS 18-21	(1) (4) STRIPS AT ROOM ENTRANCES WITH CARPET COVERING MOST OF THE FLOOR SPACE.	N
M	SHEET VINYL FLOORING & ADHESIVE	100	ASSUMED POSITIVE	50 S	CUSTODIAL OFFICE	(7) NOW BARE CONCRETE FLOOR	N
M	2' X 4' CEILING PANELS FISSURE PATTERN	150	ASSUMED POSITIVE	3,600 S	CLASSROOMS 18-21	(1) (4)	N
M	12" ACOUSTIC CEILING TILE - 1/8" HOLE PATTERN	165	ASSUMED POSITIVE	800 S	CLASSROOMS 18-21 AND WORKROOM (923)	(1) (4)	N
M	COVE BASE ADHESIVE	166	ASSUMED POSITIVE	480 LF	CLASSROOMS 18-21 - WORK ROOM (923)	(1) (4)	N
M	CARPET ADHESIVE	251	ASSUMED POSITIVE	5,000 S	CLASSROOMS 18-21	(1)	N
M	12" ACOUSTIC CEILING TILE - FISSURE PATTERN	289	ASSUMED POSITIVE	240 S	WORK ROOM (923)	(1)	N

Z:\Clients\Chico USD\13-2751 3 Year Reinspections\Sites\Sierra View ES\Sierra View HMR.wpd

CONDITION CODE

- General Condition: (1) Good (2) Damaged (3) Significantly Damaged (25% or more)
Change in Condition: (4) No (5) Yes (If Yes, explain under comments)
Abated: (6) Repaired (7) Removed (8) Encapsulated (9) Enclosed (10) Isolated & Restricted
Miscellaneous: (11) Inaccessible, no inspection data (12) Other (Explain under comments) (13) Non-Asbestos/Not Inspected

CONSULT ORIGINAL AND SUPPLEMENTARY INSPECTION REPORTS FOR MATERIALS WITH TRACE AMOUNTS OF ASBESTOS

**THREE-YEAR REINSPECTION
HOMOGENEOUS ACBM RECORDS**

Date of Inspection: August 5, 2013

District: Chico Unified School District

Inspector: Blake Howes

School: Sierra View Elementary School

Building: Unit L - Classrooms 22 & 23

Material Class	Material	Homo. Mat. #	% Asb.	Ft ² /L.F.	Location	Condition: Code & Comments	Friable Yes/No
M	SHEET VINYL FLOORING & ADHESIVE	102	ASSUMED POSITIVE	200 S	RESTROOMS (926A & B AND 927A & B)	(7) 1" CERAMIC FLOOR TILE CURRENTLY INSTALLED.	N
M	12" VINYL FLOOR TILE (WHITE / BLUE) & ADHESIVE	105	ASSUMED POSITIVE	1,200 S	CLASSROOMS 22 & 23 AND WORKROOM (925)	(1) (4)	N
M	2' X 4' CEILING PANELS FISSURE PATTERN	106	ASSUMED POSITIVE	2,400 S	CLASSROOMS 22 & 23 AND WORKROOM (925)	(1) (4)	N
M	DRYWALL & JOINT COMPOUND	150	ASSUMED POSITIVE	200 S	RESTROOMS (926 A&B), (927 A&B)	(1)	N
M	12" ACOUSTIC CEILING TILE - 1/8" HOLE PATTERN	165	ASSUMED POSITIVE	64 S	RESTROOMS (926 A&B), (927 A&B)	(1)	N
M	COVE BASE ADHESIVE	167	ASSUMED POSITIVE	280 L	CLASSROOMS 22 & 23	(1) (4)	N
M	CARPET ADHESIVE	251	ASSUMED POSITIVE	800 S	CLASSROOMS 22 & 23	(1)	N
S	STUCCO	255	ASSUMED POSITIVE	400 S	COVERED WALKWAY AT CLASSROOM ENTRIES	(1)	N

Z:\Clients\Chico USD\13-2751 3 Year Reinspections\Sites\Sierra View ES\Sierra View HMR.wpd

CONDITION CODE

- General Condition: (1) Good (2) Damaged (3) Significantly Damaged (25% or more)
Change in Condition: (4) No (5) Yes (If Yes, explain under comments)
Abated: (6) Repaired (7) Removed (8) Encapsulated (9) Enclosed (10) Isolated & Restricted
Miscellaneous: (11) Inaccessible, no inspection data (12) Other (Explain under comments) (13) Non-Asbestos/Not Inspected

CONSULT ORIGINAL AND SUPPLEMENTARY INSPECTION REPORTS FOR MATERIALS WITH TRACE AMOUNTS OF ASBESTOS

**THREE-YEAR REINSPECTION
HOMOGENEOUS ACBM RECORDS**

Date of Inspection: August 5, 2013

District: Chico Unified School District

Inspector: Blake Howes

School: Sierra View Elementary School

Building: Unit M - Portables 24-26

Material Class	Material	Homo. Mat. #	% Asb.	Ft ² /L.F.	Location	Condition: Code & Comments	Friable Yes/No
M	12" VINYL FLOOR TILE (LIGHT GRAY) & ADHESIVE	86	ASSUMED POSITIVE	720 S	PORTABLE CLASSROOMS 24-26 (NEXT TO SINKS)	(1) (4) SOME CRACKS IN CLASSROOM 25 & 26.	N
M	DRYWALL	87	ASSUMED POSITIVE	1,400 S	BOY'S (928) & GIRL'S (929) RESTROOMS, & PORTABLE CLASSROOMS 24-26	(1) (4) DRYWALL IS ASSUMED POSITIVE TO EXIST BEHIND THE TAGBOARD IN PORTABLES 24-26.	N
M	SHEET VINYL FLOORING (YELLOW) & ADHESIVE	88	ASSUMED POSITIVE	600 S	GIRL'S RESTROOM (929)	(1) (4) THESE RESTROOMS ARE ADJACENT TO PORTABLE 26.	N
M	2' X 4' CEILING PANELS FISSURE PATTERN	89	ASSUMED POSITIVE	3,000 S	PORTABLE CLASSROOMS 24-26	(1) (4)	N
M	SHEET VINYL FLOORING (WHITE) & ADHESIVE	168	ASSUMED POSITIVE	600 S	BOY'S RESTROOM (928)	(1) (4)	N
M	COVE BASE ADHESIVE	250	ASSUMED POSITIVE	250 L	PORTABLE CLASSROOMS 24-26	(1)	N
M	CARPET ADHESIVE	251	ASSUMED POSITIVE	2,000 S	PORTABLE CLASSROOMS 24-26	(1)	N
						ROOM 24 - SERIAL # 8888.13 A, B & C ROOM 25 - SERIAL # 8888.14 A, B & C ROOM 26 - SERIAL # 8888.15 A, B & C RESTROOM SERIAL # 8888.16 B	

Z:\Clients\Chico USD\13-2751 3 Year Reinspections\Sites\Sierra View ES\Sierra View HMR.wpd

CONDITION CODE

General Condition: (1) Good (2) Damaged (3) Significantly Damaged (25% or more)

Change in Condition: (4) No (5) Yes (If Yes, explain under comments)

Abated: (6) Repaired (7) Removed (8) Encapsulated (9) Enclosed (10) Isolated & Restricted

Miscellaneous: (11) Inaccessible, no inspection data (12) Other (Explain under comments) (13) Non-Asbestos/Not Inspected

CONSULT ORIGINAL AND SUPPLEMENTARY INSPECTION REPORTS FOR MATERIALS WITH TRACE AMOUNTS OF ASBESTOS

**THREE-YEAR REINSPECTION
HOMOGENEOUS ACBM RECORDS**

Date of Inspection: August 5, 2013

District: Chico Unified School District

Inspector: Blake Howes

School: Sierra View Elementary School

Building: Unit N - Portable 27

Material Class	Material	Homo. Mat. #	% Asb.	Ft ² /L.F.	Location	Condition: Code & Comments	Friable Yes/No
M	DRYWALL	84	ASSUMED POSITIVE	900 S	CLASSROOM 27	(11) BEHIND TAGBOARD COVERING	N
M	2' X 4' CEILING PANELS FIBERGLASS	85	NON-SUSPECT	900 S	CLASSROOM 27	(13)	N
M	12" VINYL FLOOR TILE (GRAY) & ADHESIVE	169	ASSUMED POSITIVE	180 S	CLASSROOM 27	(1) (4)	N
M	COVE BASE ADHESIVE	250	ASSUMED POSITIVE	120 L	CLASSROOM 27	(1)	N
M	CARPET ADHESIVE	251	ASSUMED POSITIVE	850 S	CLASSROOM 27	(1)	N
						ROOM 27 - DESIGNED MOBILE SYSTEMS IND. - 4/99 SERIAL # 20-551#1 & #2	

Z:\Clients\Chico USD\13-2751 3 Year Reinspections\Sites\Sierra View ES\Sierra View HMR.wpd

CONDITION CODE

- General Condition: (1) Good (2) Damaged (3) Significantly Damaged (25% or more)
Change in Condition: (4) No (5) Yes (If Yes, explain under comments)
Abated: (6) Repaired (7) Removed (8) Encapsulated (9) Enclosed (10) Isolated & Restricted
Miscellaneous: (11) Inaccessible, no inspection data (12) Other (Explain under comments) (13) Non-Asbestos/Not Inspected

CONSULT ORIGINAL AND SUPPLEMENTARY INSPECTION REPORTS FOR MATERIALS WITH TRACE AMOUNTS OF ASBESTOS

**ENTEK CONSULTING GROUP, INC.
ASSESSMENT OF TSI and/or FRIABLE MATERIAL**

District: Chico Unified School District

Date: August 5, 2013

School: Sierra View Elementary School

Inspector: Blake Howes

Building & Location(s): Unit D - Boiler Room

ECG- % Asbestos-60-65%

Homogeneous Mat. #12

Material description: Mud Joints

Total amount of material this location: 30 L

Amount of friable material this location: 30 L

Damage	Local		Distributed		Damaged	0%
Type of Damage	Air Erosion		Water		Flaking	
	Deterioration		Physical		Delamination	

Probable cause(s) of damage:

POTENTIAL FOR DISTURBANCE			RESPONSE ACTIONS		PREVENTIVE MEASURES	
	H	M	L	Isolate/Restrict	X	Fix leaks
Accessibility	X			Repair/Cleanup		Prevent water contact
Vibration			X	Enclose		Do not drill, cut, sand, or grind
Air Erosion			X	Remove	X	Do not affix signs
Water			X	Encapsulate		Avoid contact
Occupancy			X	O & M	X	

Assessment of Material Condition

Significantly Damaged
(Poor)

Damaged
(Fair)

Not damaged
(Good)

Potential Damage: High

High Mod Low

High Mod Low

Hazard Ranking:

1 2 3 4 5 6 7

							X	
--	--	--	--	--	--	--	---	--

Comments & Observations:

**ENTEK CONSULTING GROUP, INC.
ASSESSMENT OF TSI and/or FRIABLE MATERIAL**

District: Chico Unified School District

Date: August 5, 2013

School: Sierra View Elementary School

Inspector: Blake Howes

Building & Location(s): Unit J - Boiler Room

ECG-

% Asbestos-Assumed

Homogeneous Mat. #98

Material description: Hard Packed TSI Flue Encased With Metal

Total amount of material this location: 12 L

Amount of friable material this location: 12 L

Damage	Local		Distributed		Damaged	0%
Type of Damage	Air Erosion		Water		Flaking	
	Deterioration		Physical		Delamination	

Probable cause(s) of damage:

POTENTIAL FOR DISTURBANCE			RESPONSE ACTIONS		PREVENTIVE MEASURES	
	H	M	L			
				Isolate/Restrict		Fix leaks
Accessibility			X	Repair/Cleanup		Prevent water contact
Vibration			X	Enclose		Do not drill, cut, sand, or grind
Air Erosion			X	Remove		Do not affix signs
Water			X	Encapsulate		Avoid contact
Occupancy			X	O & M	X	

Assessment of Material Condition

Significantly Damaged
(Poor)

Damaged
(Fair)

Not damaged
(Good)

Potential Damage: High

High Mod Low

High Mod Low

Hazard Ranking:

1 2 3 4 5 6 7

								X
--	--	--	--	--	--	--	--	---

Comments & Observations:

**ENTEK CONSULTING GROUP, INC.
ASSESSMENT OF TSI and/or FRIABLE MATERIAL**

District: Chico Unified School District

Date: August 5, 2013

School: Sierra View Elementary School

Inspector: Blake Howes

Building & Location(s): Unit D - Boiler Room

ECG-

% Asbestos-Assumed

Homogeneous Mat. #156

Material description: Boiler Insulation

Total amount of material this location: 1 Boiler Unit

Amount of friable material this location: 1 Boiler Unit

Damage	Local		Distributed		Damaged	0%
Type of Damage	Air Erosion		Water		Flaking	
	Deterioration		Physical		Delamination	

Probable cause(s) of damage:

POTENTIAL FOR DISTURBANCE			RESPONSE ACTIONS		PREVENTIVE MEASURES	
	H	M	L			
				Isolate/Restrict		Fix leaks
Accessibility			X	Repair/Cleanup		Prevent water contact
Vibration			X	Enclose		Do not drill, cut, sand, or grind
Air Erosion			X	Remove	X	Do not affix signs
Water			X	Encapsulate		Avoid contact
Occupancy			X	O & M	X	

Assessment of Material Condition

Significantly Damaged
(Poor)

Damaged
(Fair)

Not damaged
(Good)

Potential Damage: High

High Mod Low

High Mod Low

Hazard Ranking:

1 2 3 4 5 6 7

								X
--	--	--	--	--	--	--	--	---

Comments & Observations:



Sierra View Elementary School

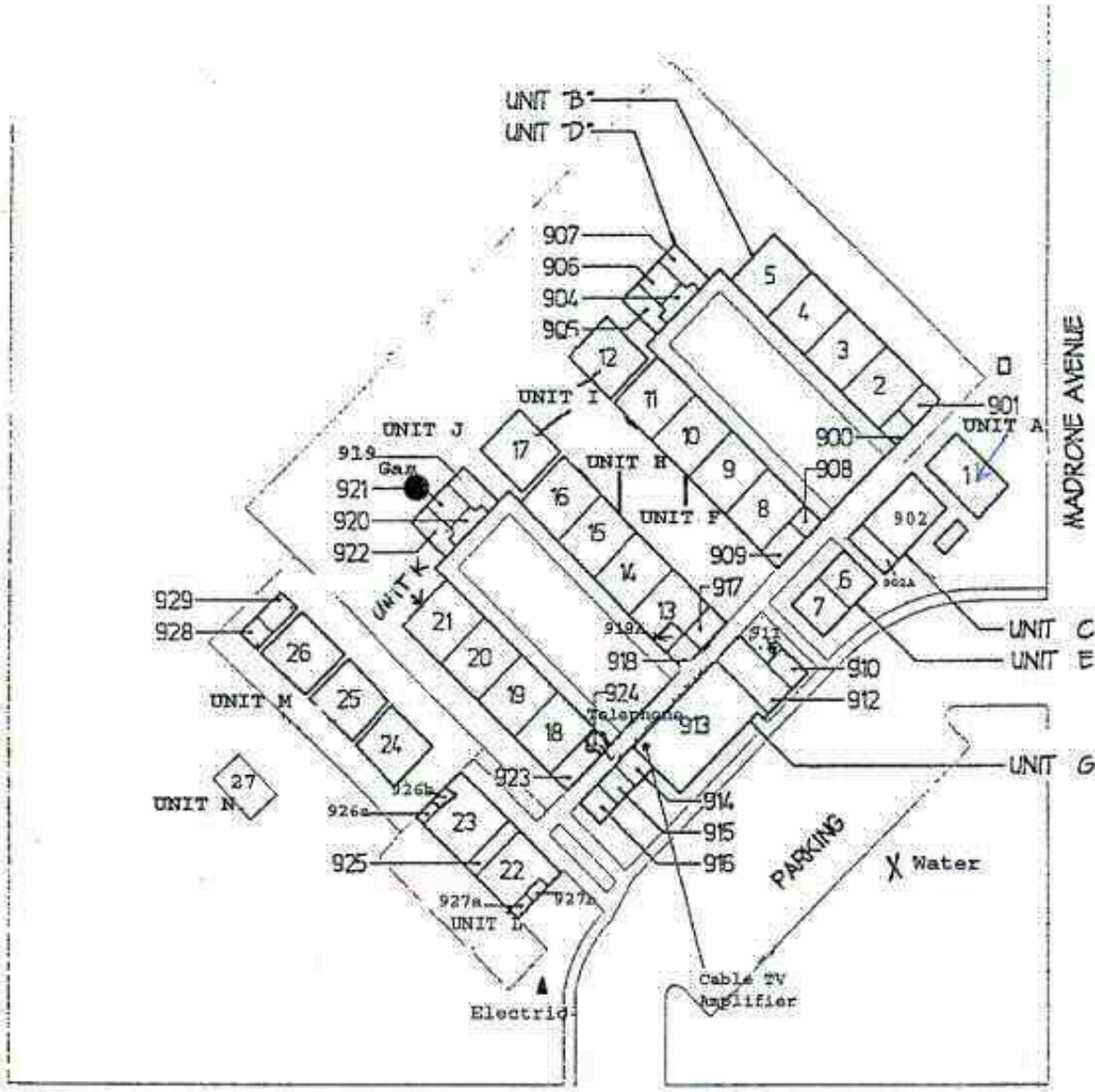

Blake Howes

Chico Unified School District
Sierra View School
1598 Hooker Oak Avenue
Chico, CA 95926

Entek Consulting Group, Inc.
4200 Rocklin Road, Suite 7
Rocklin, California 95677
Map Not To Scale

3-Year AHERA Reinspection
Conducted by Blake Howes
August 5, 2013
Project 13-2751

SIX-MONTH SURVEILLANCE

**SIX MONTH SURVEILLANCE
HOMOGENEOUS ACBM RECORDS**

Date of Inspection:

District: Chico Unified School District
School: Sierra View Elementary School

Inspector:
Building: Unit A - Classroom 1

Material Class	Material	Homo. Mat. #	% Asb.	Ft ² /L.F.	Location	Condition: Code & Comments	Friable Yes/No
M	DRYWALL	93	ASSUMED POSITIVE	1,250 S	CLASSROOM 1	(4) (11) EXISTS BEHIND TAGBOARD.	N
M	2' X 4' CEILING PANELS FISSURE PATTERN	99	ASSUMED POSITIVE	960 S	CLASSROOM 1	(1) (4)	N
M	COVE BASE ADHESIVE	250	ASSUMED POSITIVE	120 L	CLASSROOM 1	(1)	N
M	CARPET ADHESIVE	251	ASSUMED POSITIVE	850 S	CLASSROOM 1	(1)	N

Z:\Clients\Chico USD\13-2751 3 Year Reinspections\Sites\Sierra View ES\Sierra View 6 month.wpd

CONDITION CODE

General Condition: (1) Good (2) Damaged (3) Significantly Damaged (25% or more)

Change in Condition: (4) No (5) Yes (If Yes, explain under comments)

Abated: (6) Repaired (7) Removed (8) Encapsulated (9) Enclosed (10) Isolated & Restricted

Miscellaneous: (11) Inaccessible, no inspection data (12) Other (Explain under comments) (13) Non-Asbestos/Not Inspected

CONSULT ORIGINAL AND SUPPLEMENTARY INSPECTION REPORTS FOR MATERIALS WITH TRACE AMOUNTS OF ASBESTOS

**SIX MONTH SURVEILLANCE
HOMOGENEOUS ACBM RECORDS**

Date of Inspection: Date of Inspection:

District: Chico Unified School District
School: Sierra View Elementary School

Inspector:
Building: Unit B - Classrooms 2-5

Material Class	Material	Homo. Mat. #	% Asb.	Ft ² /L.F.	Location	Condition: Code & Comments	Friable Yes/No
S	PLASTER	3	1-5%	400 S	SPEECH ROOMS	(1) (4)	N
M	9" VINYL FLOOR TILE (GREEN) & ADHESIVE	14	1-5%	4,000 S	CLASSROOMS 2-5 AND SPEECH ROOMS	(1) (4)	N
M	TRANSITE PANELS	83	ASSUMED POSITIVE	25 PANELS	UNDER WINDOWS THROUGHOUT BUILDING	(1) (4)	N
M	12" ACOUSTIC CEILING TILE- 1/8" HOLE PATTERN	17	ASSUMED POSITIVE	4,000 S	CLASSROOMS 2-5 AND SPEECH ROOMS	(1) (4)	N
M	COVE BASE ADHESIVE	157	ASSUMED POSITIVE	600 LF	CLASSROOMS 2-5 AND SPEECH ROOMS	(1) (4)	N
M	9" VINYL FLOOR TILE (GRAY) & ADHESIVE	158	ASSUMED POSITIVE	400 S	SPEECH ROOMS	(1) (4)	N
M	STUCCO	255	ASSUMED POSITIVE	200 S	COVERED WALKWAY AT EAST END	(1)	N

Z:\Clients\Chico USD\13-2751 3 Year Reinspections\Sites\Sierra View ES\Sierra View 6 month.wpd

CONDITION CODE

General Condition: (1) Good (2) Damaged (3) Significantly Damaged (25% or more)

Change in Condition: (4) No (5) Yes (If Yes, explain under comments)

Abated: (6) Repaired (7) Removed (8) Encapsulated (9) Enclosed (10) Isolated & Restricted

Miscellaneous: (11) Inaccessible, no inspection data (12) Other (Explain under comments) (13) Non-Asbestos/Not Inspected

CONSULT ORIGINAL AND SUPPLEMENTARY INSPECTION REPORTS FOR MATERIALS WITH TRACE AMOUNTS OF ASBESTOS

**SIX MONTH SURVEILLANCE
HOMOGENEOUS ACBM RECORDS**

Date of Inspection: Date of Inspection:

District: Chico Unified School District
School: Sierra View Elementary School

Inspector:
Building: Unit C - Library

Material Class	Material	Homo. Mat. #	% Asb.	Ft ² /L.F.	Location	Condition: Code & Comments	Friable Yes/No
M	12" ACOUSTIC CEILING TILE	97	ASSUMED POSITIVE	600 S	LIBRARY (902), AND ANNEX (902A)	(1) (4)	N
M	DRYWALL & JOINT COMPOUND	260	ASSUMED POSITIVE	1,500 S	LIBRARY (902) & ANNEX (902A) AT WALLS & CEILINGS	(1)	N
M	COVE BASE ADHESIVE	250	ASSUMED POSITIVE	400 L	LIBRARY (902), AND ANNEX (902A)	(1)	N
M	CARPET ADHESIVE	251	ASSUMED POSITIVE	1,150 S	LIBRARY (902), AND ANNEX (902A)	(1) (4)	N

Z:\Clients\Chico USD\13-2751 3 Year Reinspections\Sites\Sierra View ES\Sierra View 6 month.wpd

CONDITION CODE

General Condition: (1) Good (2) Damaged (3) Significantly Damaged (25% or more)

Change in Condition: (4) No (5) Yes (If Yes, explain under comments)

Abated: (6) Repaired (7) Removed (8) Encapsulated (9) Enclosed (10) Isolated & Restricted

Miscellaneous: (11) Inaccessible, no inspection data (12) Other (Explain under comments) (13) Non-Asbestos/Not Inspected

CONSULT ORIGINAL AND SUPPLEMENTARY INSPECTION REPORTS FOR MATERIALS WITH TRACE AMOUNTS OF ASBESTOS

**SIX MONTH SURVEILLANCE
HOMOGENEOUS ACBM RECORDS**

Date of Inspection: Date of Inspection:

District: Chico Unified School District
School: Sierra View Elementary School

Inspector:
Building: Unit D - Restroom Bldg.

Material Class	Material	Homo. Mat. #	% Asb.	Ft ² /L.F.	Location	Condition: Code & Comments	Friable Yes/No
M	PLASTER	3	1-5%	1,500 S	CUSTODIAN CLOSET (904), BOY'S (907) & GIRL'S (905) RESTROOMS	(1) (4)	N
T	MUD JOINT	12	60-65%	30 L	BOILER ROOM (906)	(1) (4)	Y
M	DRYWALL & JOINT COMPOUND	150	N/A	N/A	BOY'S (907) & GIRL'S (905) RESTROOMS	(12) MATERIAL MISIDENTIFIED - RESTROOM WALLS & CEILINGS ARE PLASTER, SQUARE FOOTAGE ADDED TO HOMOGENEOUS MATERIAL #3	N/A
T	BOILER INSULATION	156	ASSUMED POSITIVE	1 UNIT	BOILER ROOM (906)	(1) (4)	Y

Z:\Clients\Chico USD\13-2751 3 Year Reinspections\Sites\Sierra View ES\Sierra View 6 month.wpd

CONDITION CODE

General Condition: (1) Good (2) Damaged (3) Significantly Damaged (25% or more)

Change in Condition: (4) No (5) Yes (If Yes, explain under comments)

Abated: (6) Repaired (7) Removed (8) Encapsulated (9) Enclosed (10) Isolated & Restricted

Miscellaneous: (11) Inaccessible, no inspection data (12) Other (Explain under comments) (13) Non-Asbestos/Not Inspected

CONSULT ORIGINAL AND SUPPLEMENTARY INSPECTION REPORTS FOR MATERIALS WITH TRACE AMOUNTS OF ASBESTOS

**SIX MONTH SURVEILLANCE
HOMOGENEOUS ACBM RECORDS**

Date of Inspection: Date of Inspection:

District: Chico Unified School District
School: Sierra View Elementary School

Inspector:
Building: Unit E - Classrooms 6 & 7

Material Class	Material	Homo. Mat. #	% Asb.	Ft ² /L.F.	Location	Condition: Code & Comments	Friable Yes/No
M	DRYWALL	93	ASSUMED POSITIVE	1,700 SF	CLASSROOMS 6 & 7	(11) EXISTS BEHIND TAGBOARD.	N
M	12" VINYL FLOOR TILE & ADHESIVE	94	ASSUMED POSITIVE	120 S	CLASSROOM 6	(1) (4)	N
M	2' X 4' CEILING PANELS	99	ASSUMED POSITIVE	960 S	CLASSROOMS 6 & 7	(1) (4)	N
M	COVE BASE ADHESIVE	250	ASSUMED POSITIVE	175 L	CLASSROOMS 6 & 7	(1)	N
M	CARPET ADHESIVE	251	ASSUMED POSITIVE	900 S	CLASSROOMS 6 & 7	(1)	N

Z:\Clients\Chico USD\13-2751 3 Year Reinspections\Sites\Sierra View ES\Sierra View 6 month.wpd

CONDITION CODE

General Condition: (1) Good (2) Damaged (3) Significantly Damaged (25% or more)

Change in Condition: (4) No (5) Yes (If Yes, explain under comments)

Abated: (6) Repaired (7) Removed (8) Encapsulated (9) Enclosed (10) Isolated & Restricted

Miscellaneous: (11) Inaccessible, no inspection data (12) Other (Explain under comments) (13) Non-Asbestos/Not Inspected

CONSULT ORIGINAL AND SUPPLEMENTARY INSPECTION REPORTS FOR MATERIALS WITH TRACE AMOUNTS OF ASBESTOS

**SIX MONTH SURVEILLANCE
HOMOGENEOUS ACBM RECORDS**

Date of Inspection: Date of Inspection:

District: Chico Unified School District
School: Sierra View Elementary School

Inspector:
Building: Unit F - Classrooms 8 - 11

Material Class	Material	Homo. Mat. #	% Asb.	Ft ² /L.F.	Location	Condition: Code & Comments	Friable Yes/No
S	PLASTER	3	1-5%	400 S	PIP ROOM (909) AND NURSES ROOM	(1) (4)	N
M	9" VINYL FLOOR TILE (GREEN) & ADHESIVE	14	1-5%	4,000 S	CLASSROOMS 8-11	(1) (4)	N
M	TRANSITE PANELS	83	ASSUMED POSITIVE	25 PANELS	UNDER WINDOWS THROUGHOUT BUILDING	(1) (4)	N
M	12" ACOUSTIC CEILING TILE - 1/8" HOLE PATTERN	97	ASSUMED POSITIVE	4,000 S	CLASSROOMS 8-11	(1) (4)	N
M	SHEET VINYL FLOORING & ADHESIVE	100	ASSUMED POSITIVE	50 S	RESTROOM (908)	(7)	N
M	9" VINYL FLOOR TILE (GRAY) & ADHESIVE	170	ASSUMED POSITIVE	500 S	RESTROOM (908), PIP ROOM (909), AND NURSES ROOM	(2) (5) DAMAGED AT RESTROOM (908) ENTRY	N
M	COVE BASE ADHESIVE	171	ASSUMED POSITIVE	520 LF	CLASSROOMS 8-11 & NURSE ROOM	(1) (4)	N
S	STUCCO	255	ASSUMED POSITIVE	300 S	COVERED WALKWAY @ EAST END OF BUILDING	(1)	N

Z:\Clients\Chico USD\13-2751 3 Year Reinspections\Sites\Sierra View ES\Sierra View 6 month.wpd

CONDITION CODE

General Condition: (1) Good (2) Damaged (3) Significantly Damaged (25% or more)

Change in Condition: (4) No (5) Yes (If Yes, explain under comments)

Abated: (6) Repaired (7) Removed (8) Encapsulated (9) Enclosed (10) Isolated & Restricted

Miscellaneous: (11) Inaccessible, no inspection data (12) Other (Explain under comments) (13) Non-Asbestos/Not Inspected

CONSULT ORIGINAL AND SUPPLEMENTARY INSPECTION REPORTS FOR MATERIALS WITH TRACE AMOUNTS OF ASBESTOS

**SIX MONTH SURVEILLANCE
HOMOGENEOUS ACBM RECORDS**

Date of Inspection: Date of Inspection:

District: Chico Unified School District
School: Sierra View Elementary School

Inspector:
Building: Unit G - MPR

Material Class	Material	Homo. Mat. #	% Asb.	Ft ² /L.F.	Location	Condition: Code & Comments	Friable Yes/No
S	PLASTER	3	1-5%	1,200 S	KITCHEN (912), KITCHEN STORAGE (910), AND MPR CHAIR STORAGE	(1) (4)	N
T	PIPE WRAP INSULATION	8	15-20%	13 L	MECHANICAL ROOM (911)	(7)	
M	TRANSITE (CEMENTITIOUS) PIPE FLUE	98	ASSUMED POSITIVE	20 L	HOT WATER ROOM	(1) (4) THIS MATERIAL IS LOCATED IN THE MECHANICAL ROOM (911)	N
M	SHEET VINYL FLOORING (WHITE) & ADHESIVE	152	ASSUMED POSITIVE	50 S	KITCHEN RESTROOM	(1) (4)	N
M	DRYWALL	153	ASSUMED POSITIVE	3,000 S	OFFICES AND MPR (913) CEILINGS	(1) (4)	N
M	12" VINYL FLOOR TILE (WHITE / BLUE) & ADHESIVE	154	ASSUMED POSITIVE	3,500 S	OFFICE HALLWAY (914-916) & MPR (913)	(1) (4)	N
M	12" ACOUSTIC CEILING TILE - FISSURE PATTERN	155	ASSUMED POSITIVE	2,000 S	OFFICE HALLWAY CEILING, ALL THREE OFFICES (914-916), AND MPR (913)	(1) (4)	N
M	SHEET VINYL FLOORING (TAN) & ADHESIVE	159	ASSUMED POSITIVE	500 S	KITCHEN (912)	(1) (4)	N
M	COVE BASE ADHESIVE	250	ASSUMED POSITIVE	400 L	OFFICES (914-916), AND MPR (913)	(1)	N

Z:\Clients\Chico USD\13-2751 3 Year Reinspections\Sites\Sierra View ES\Sierra View 6 month.wpd

CONDITION CODE

General Condition: (1) Good (2) Damaged (3) Significantly Damaged (25% or more)

Change in Condition: (4) No (5) Yes (If Yes, explain under comments)

Abated: (6) Repaired (7) Removed (8) Encapsulated (9) Enclosed (10) Isolated & Restricted

Miscellaneous: (11) Inaccessible, no inspection data (12) Other (Explain under comments) (13) Non-Asbestos/Not Inspected

CONSULT ORIGINAL AND SUPPLEMENTARY INSPECTION REPORTS FOR MATERIALS WITH TRACE AMOUNTS OF ASBESTOS

**SIX MONTH SURVEILLANCE
HOMOGENEOUS ACBM RECORDS**

Date of Inspection:

District: Chico Unified School District
School: Sierra View Elementary School

Inspector:
Building: Unit G - MPR
(Continued)

Material Class	Material	Homo. Mat. #	% Asb.	Ft ² /L.F.	Location	Condition: Code & Comments	Friable Yes/No
M	SHEET VINYL FLOORING (GRAY) & ADHESIVE	268	ASSUMED POSITIVE	40 S	RESTROOM AT OFFICE (914)	(1)	N
M	COVE BASE ADHESIVE	270	ASSUMED POSITIVE	200 L	OFFICE HALLWAY	(1)	N
S	WALL TEXTURE	295	ASSUMED POSITIVE	700 S	OFFICES (914-916)	(1)	N

Z:\Clients\Chico USD\13-2751 3 Year Reinspections\Sites\Sierra View ES\Sierra View 6 month.wpd

CONDITION CODE

General Condition: (1) Good (2) Damaged (3) Significantly Damaged (25% or more)

Change in Condition: (4) No (5) Yes (If Yes, explain under comments)

Abated: (6) Repaired (7) Removed (8) Encapsulated (9) Enclosed (10) Isolated & Restricted

Miscellaneous: (11) Inaccessible, no inspection data (12) Other (Explain under comments) (13) Non-Asbestos/Not Inspected

CONSULT ORIGINAL AND SUPPLEMENTARY INSPECTION REPORTS FOR MATERIALS WITH TRACE AMOUNTS OF ASBESTOS

**SIX MONTH SURVEILLANCE
HOMOGENEOUS ACBM RECORDS**

District: Chico Unified School District
School: Sierra View Elementary School

Date of Inspection:
Inspector:
Building: Unit H - Classrooms 13-16

Material Class	Material	Homo. Mat. #	% Asb.	Ft ² /L.F.	Location	Condition: Code & Comments	Friable Yes/No
M	TRANSITE PANELS	83	ASSUMED POSITIVE	4,500 S	STAFF ROOM (917) & CLASSROOMS 13-16	(1) (4)	N
M	12" VINYL FLOOR TILE (BLUE / WHITE) & ADHESIVE	94	ASSUMED POSITIVE	720 S	STAFF ROOM (917) & CLASSROOMS 13-16	(1) (4) STRIPS AT ROOM ENTRANCES WITH CARPET COVERING THE MAJORITY OF FLOOR SPACE.	N
M	2' X 4' CEILING PANELS FISSURE PATTERN	150	ASSUMED POSITIVE	3,600 S	STAFF ROOM (917) & CLASSROOMS 13-16	(1) (4)	N
M	SHEET VINYL FLOORING (BLUE & WHITE) & ADHESIVE	151	ASSUMED POSITIVE	100 S	MEN'S (918) & WOMEN'S (918A) RESTROOMS	(1) (4)	N
M	12" ACOUSTIC CEILING TILE - 1/8" HOLE PATTERN	160	ASSUMED POSITIVE	600 S	CLASSROOMS 13-16	(1) (4)	N
M	COVE BASE ADHESIVE	161	ASSUMED POSITIVE	480 S	CLASSROOMS 13-16	(1) (4)	N
M	CARPET ADHESIVE	251	ASSUMED POSITIVE	2,400 S	CLASSROOMS 13-16	(1)	N
M	DRYWALL & JOINT COMPOUND	300	ASSUMED POSITIVE	550 S	MEN'S (917) & WOMEN'S (918A) RESTROOMS	(1)	N
S	DRYWALL TEXTURE	301	ASSUMED POSITIVE	150 S	MEN'S (917) & WOMEN'S (918A) RESTROOMS	(1)	N

Z:\Clients\Chico USD\13-2751 3 Year Reinspections\Sites\Sierra View ES\Sierra View 6 month.wpd

CONDITION CODE

General Condition: (1) Good (2) Damaged (3) Significantly Damaged (25% or more)

Change in Condition: (4) No (5) Yes (If Yes, explain under comments)

Abated: (6) Repaired (7) Removed (8) Encapsulated (9) Enclosed (10) Isolated & Restricted

Miscellaneous: (11) Inaccessible, no inspection data (12) Other (Explain under comments) (13) Non-Asbestos/Not Inspected

CONSULT ORIGINAL AND SUPPLEMENTARY INSPECTION REPORTS FOR MATERIALS WITH TRACE AMOUNTS OF ASBESTOS

**SIX MONTH SURVEILLANCE
HOMOGENEOUS ACBM RECORDS**

Date of Inspection:

District: Chico Unified School District
School: Sierra View Elementary School

Inspector:
Building: Unit I - Classrooms 12 & 17

Material Class	Material	Homo. Mat. #	% Asb.	Ft ² /L.F.	Location	Condition: Code & Comments	Friable Yes/No
M	2' X 4' CEILING PANELS FISSURE PATTERN	95	ASSUMED POSITIVE	1,920 S	CLASSROOMS 12 & 17	(1) (4)	N
M	12" VINYL FLOOR TILE (WHITE) & ADHESIVE	110	ASSUMED POSITIVE	250 S	CLASSROOM 12	(1) (4)	N
M	12" VINYL FLOOR TILE (WHITE) & ADHESIVE	162	ASSUMED POSITIVE	480 S	CLASSROOMS 12 & 17	(1) (4)	N
M	DRYWALL	163	ASSUMED POSITIVE	1,000 S	CLASSROOMS 12 & 17	(11) DRYWALL EXISTS BEHIND TAGBOARD.	N
M	COVE BASE ADHESIVE	250	ASSUMED POSITIVE	160 L	CLASSROOMS 12 & 17	(1)	N
M	CARPET ADHESIVE	251	ASSUMED POSITIVE	1,440 S	CLASSROOMS 12 & 17	(1)	N

Z:\Clients\Chico USD\13-2751 3 Year Reinspections\Sites\Sierra View ES\Sierra View 6 month.wpd

CONDITION CODE

General Condition: (1) Good (2) Damaged (3) Significantly Damaged (25% or more)

Change in Condition: (4) No (5) Yes (If Yes, explain under comments)

Abated: (6) Repaired (7) Removed (8) Encapsulated (9) Enclosed (10) Isolated & Restricted

Miscellaneous: (11) Inaccessible, no inspection data (12) Other (Explain under comments) (13) Non-Asbestos/Not Inspected

CONSULT ORIGINAL AND SUPPLEMENTARY INSPECTION REPORTS FOR MATERIALS WITH TRACE AMOUNTS OF ASBESTOS

**SIX MONTH SURVEILLANCE
HOMOGENEOUS ACBM RECORDS**

Date of Inspection:

District: Chico Unified School District
School: Sierra View Elementary School

Inspector:
Building: Unit J - Restrooms Bldg.

Material Class	Material	Homo. Mat. #	% Asb.	Ft ² /L.F.	Location	Condition: Code & Comments	Friable Yes/No
S	WALL PLASTER	4	ASSUMED POSITIVE	1,000 S	GIRL'S (922) & BOY'S (919) RESTROOM & CUSTODIAN CLOSET (920)	(1) (4) MINOR CRACKS.	N
T	HARD PACKED TSI FLUE ENCASED WITH METAL	98	ASSUMED POSITIVE	12 L	BOILER ROOM (921)	(11) THIS MATERIAL IS ENCASED IN METAL JACKET AND NOT ABLE TO BE ASSESSED - ASSUMED TO BE IN GOOD CONDITION.	Y
M	DRYWALL	164	ASSUMED POSITIVE	1,000 LF	BOY'S (919) & GIRL'S (922) RESTROOMS	(1) (4)	N

Z:\Clients\Chico USD\13-2751 3 Year Reinspections\Sites\Sierra View ES\Sierra View 6 month.wpd

CONDITION CODE

General Condition: (1) Good (2) Damaged (3) Significantly Damaged (25% or more)
Change in Condition: (4) No (5) Yes (If Yes, explain under comments)
Abated: (6) Repaired (7) Removed (8) Encapsulated (9) Enclosed (10) Isolated & Restricted
Miscellaneous: (11) Inaccessible, no inspection data (12) Other (Explain under comments) (13) Non-Asbestos/Not Inspected

CONSULT ORIGINAL AND SUPPLEMENTARY INSPECTION REPORTS FOR MATERIALS WITH TRACE AMOUNTS OF ASBESTOS

**SIX MONTH SURVEILLANCE
HOMOGENEOUS ACBM RECORDS**

Date of Inspection:

District: Chico Unified School District
School: Sierra View Elementary School

Inspector:
Building: Unit K - Classrooms 18-21

Material Class	Material	Homo. Mat. #	% Asb.	Ft ² /L.F.	Location	Condition: Code & Comments	Friable Yes/No
S	PLASTER	4	ASSUMED POSITIVE	6,000 S	CEILINGS AT CLASSROOMS 18-21, CUSTODIAN (924)	(1)	N
M	TRANSITE PANELS	83	ASSUMED POSITIVE	16 PANELS	UNDER WINDOWS THROUGHOUT BUILDING	(1) (4)	N
M	12" VINYL FLOOR TILE (BLUE / WHITE) & ADHESIVE	94	ASSUMED POSITIVE	720 S	WORKROOM (923) & CLASSROOMS 18-21	(1) (4) STRIPS AT ROOM ENTRANCES WITH CARPET COVERING MOST OF THE FLOOR SPACE.	N
M	SHEET VINYL FLOORING & ADHESIVE	100	ASSUMED POSITIVE	50 S	CUSTODIAL OFFICE	(7) NOW BARE CONCRETE FLOOR	N
M	2' X 4' CEILING PANELS FISSURE PATTERN	150	ASSUMED POSITIVE	3,600 S	CLASSROOMS 18-21	(1) (4)	N
M	12" ACOUSTIC CEILING TILE - 1/8" HOLE PATTERN	165	ASSUMED POSITIVE	800 S	CLASSROOMS 18-21 AND WORKROOM (923)	(1) (4)	N
M	COVE BASE ADHESIVE	166	ASSUMED POSITIVE	480 LF	CLASSROOMS 18-21 - WORK ROOM (923)	(1) (4)	N
M	CARPET ADHESIVE	251	ASSUMED POSITIVE	5,000 S	CLASSROOMS 18-21	(1)	N
M	12" ACOUSTIC CEILING TILE - FISSURE PATTERN	289	ASSUMED POSITIVE	240 S	WORK ROOM (923)	(1)	N

Z:\Clients\Chico USD\13-2751 3 Year Reinspections\Sites\Sierra View ES\Sierra View 6 month.wpd

CONDITION CODE

General Condition: (1) Good (2) Damaged (3) Significantly Damaged (25% or more)

Change in Condition: (4) No (5) Yes (If Yes, explain under comments)

Abated: (6) Repaired (7) Removed (8) Encapsulated (9) Enclosed (10) Isolated & Restricted

Miscellaneous: (11) Inaccessible, no inspection data (12) Other (Explain under comments) (13) Non-Asbestos/Not Inspected

CONSULT ORIGINAL AND SUPPLEMENTARY INSPECTION REPORTS FOR MATERIALS WITH TRACE AMOUNTS OF ASBESTOS

**SIX MONTH SURVEILLANCE
HOMOGENEOUS ACBM RECORDS**

Date of Inspection:

District: Chico Unified School District
School: Sierra View Elementary School

Inspector:
Building: Unit L - Classrooms 22 & 23

Material Class	Material	Homo. Mat. #	% Asb.	Ft ² /L.F.	Location	Condition: Code & Comments	Friable Yes/No
M	SHEET VINYL FLOORING & ADHESIVE	102	ASSUMED POSITIVE	200 S	RESTROOMS (926A & B AND 927A & B)	(7) 1" CERAMIC FLOOR TILE CURRENTLY INSTALLED.	N
M	12" VINYL FLOOR TILE (WHITE / BLUE) & ADHESIVE	105	ASSUMED POSITIVE	1,200 S	CLASSROOMS 22 & 23 AND WORKROOM (925)	(1) (4)	N
M	2' X 4' CEILING PANELS FISSURE PATTERN	106	ASSUMED POSITIVE	2,400 S	CLASSROOMS 22 & 23 AND WORKROOM (925)	(1) (4)	N
M	DRYWALL & JOINT COMPOUND	150	ASSUMED POSITIVE	200 S	RESTROOMS (926 A&B), (927 A&B)	(1)	N
M	12" ACOUSTIC CEILING TILE - 1/8" HOLE PATTERN	165	ASSUMED POSITIVE	64 S	RESTROOMS (926 A&B), (927 A&B)	(1)	N
M	COVE BASE ADHESIVE	167	ASSUMED POSITIVE	280 L	CLASSROOMS 22 & 23	(1) (4)	N
M	CARPET ADHESIVE	251	ASSUMED POSITIVE	800 S	CLASSROOMS 22 & 23	(1)	N
S	STUCCO	255	ASSUMED POSITIVE	400 S	COVERED WALKWAY AT CLASSROOM ENTRIES	(1)	N

Z:\Clients\Chico USD\13-2751 3 Year Reinspections\Sites\Sierra View ES\Sierra View 6 month.wpd

CONDITION CODE

General Condition: (1) Good (2) Damaged (3) Significantly Damaged (25% or more)

Change in Condition: (4) No (5) Yes (If Yes, explain under comments)

Abated: (6) Repaired (7) Removed (8) Encapsulated (9) Enclosed (10) Isolated & Restricted

Miscellaneous: (11) Inaccessible, no inspection data (12) Other (Explain under comments) (13) Non-Asbestos/Not Inspected

CONSULT ORIGINAL AND SUPPLEMENTARY INSPECTION REPORTS FOR MATERIALS WITH TRACE AMOUNTS OF ASBESTOS

**SIX MONTH SURVEILLANCE
HOMOGENEOUS ACBM RECORDS**

Date of Inspection:

District: Chico Unified School District
School: Sierra View Elementary School

Inspector:
Building: Unit M - Portables 24-26

Material Class	Material	Homo. Mat. #	% Asb.	Ft ² /L.F.	Location	Condition: Code & Comments	Friable Yes/No
M	12" VINYL FLOOR TILE (LIGHT GRAY) & ADHESIVE	86	ASSUMED POSITIVE	720 S	PORTABLE CLASSROOMS 24-26 (NEXT TO SINKS)	(1) (4) SOME CRACKS IN CLASSROOM 25 & 26.	N
M	DRYWALL	87	ASSUMED POSITIVE	1,400 S	BOY'S (928) & GIRL'S (929) RESTROOMS, & PORTABLE CLASSROOMS 24-26	(1) (4) DRYWALL IS ASSUMED POSITIVE TO EXIST BEHIND THE TAGBOARD IN PORTABLES 24-26.	N
M	SHEET VINYL FLOORING (YELLOW) & ADHESIVE	88	ASSUMED POSITIVE	600 S	GIRL'S RESTROOM (929)	(1) (4) THESE RESTROOMS ARE ADJACENT TO PORTABLE 26.	N
M	2' X 4' CEILING PANELS FISSURE PATTERN	89	ASSUMED POSITIVE	3,000 S	PORTABLE CLASSROOMS 24-26	(1) (4)	N
M	SHEET VINYL FLOORING (WHITE) & ADHESIVE	168	ASSUMED POSITIVE	600 S	BOY'S RESTROOM (928)	(1) (4)	N
M	COVE BASE ADHESIVE	250	ASSUMED POSITIVE	250 L	PORTABLE CLASSROOMS 24-26	(1)	N
M	CARPET ADHESIVE	251	ASSUMED POSITIVE	2,000 S	PORTABLE CLASSROOMS 24-26	(1)	N
						ROOM 24 - SERIAL # 8888.13 A, B & C ROOM 25 - SERIAL # 8888.14 A, B & C ROOM 26 - SERIAL # 8888.15 A, B & C RESTROOM SERIAL # 8888.16 B	

Z:\Clients\Chico USD\13-2751 3 Year Reinspections\Sites\Sierra View ES\Sierra View 6 month.wpd

CONDITION CODE

General Condition: (1) Good (2) Damaged (3) Significantly Damaged (25% or more)

Change in Condition: (4) No (5) Yes (If Yes, explain under comments)

Abated: (6) Repaired (7) Removed (8) Encapsulated (9) Enclosed (10) Isolated & Restricted

Miscellaneous: (11) Inaccessible, no inspection data (12) Other (Explain under comments) (13) Non-Asbestos/Not Inspected

CONSULT ORIGINAL AND SUPPLEMENTARY INSPECTION REPORTS FOR MATERIALS WITH TRACE AMOUNTS OF ASBESTOS

**SIX MONTH SURVEILLANCE
HOMOGENEOUS ACBM RECORDS**

Date of Inspection:

District: Chico Unified School District
School: Sierra View Elementary School

Inspector:
Building: Unit N - Portable 27

Material Class	Material	Homo. Mat. #	% Asb.	Ft ² /L.F.	Location	Condition: Code & Comments	Friable Yes/No
M	DRYWALL	84	ASSUMED POSITIVE	900 S	CLASSROOM 27	(11) BEHIND TAGBOARD COVERING	N
M	2' X 4' CEILING PANELS FIBERGLASS	85	NON-SUSPECT	900 S	CLASSROOM 27	(13)	N
M	12" VINYL FLOOR TILE (GRAY) & ADHESIVE	169	ASSUMED POSITIVE	180 S	CLASSROOM 27	(1) (4)	N
M	COVE BASE ADHESIVE	250	ASSUMED POSITIVE	120 L	CLASSROOM 27	(1)	N
M	CARPET ADHESIVE	251	ASSUMED POSITIVE	850 S	CLASSROOM 27	(1)	N
						ROOM 27 - DESIGNED MOBILE SYSTEMS IND. - 4/99 SERIAL # 20-551#1 & #2	

CONDITION CODE

General Condition: (1) Good (2) Damaged (3) Significantly Damaged (25% or more)

Change in Condition: (4) No (5) Yes (If Yes, explain under comments)

Abated: (6) Repaired (7) Removed (8) Encapsulated (9) Enclosed (10) Isolated & Restricted

Miscellaneous: (11) Inaccessible, no inspection data (12) Other (Explain under comments) (13) Non-Asbestos/Not Inspected

CONSULT ORIGINAL AND SUPPLEMENTARY INSPECTION REPORTS FOR MATERIALS WITH TRACE AMOUNTS OF ASBESTOS